

Volume 12 No. 2

# BRANCHING OUT

LIVING BRANCHES

*Live & Grow – Together*

## LIFE *Blossoms*

AT LIVING BRANCHES

INSIDE THIS ISSUE: DETAILS ON THE CAMPAIGN FOR LIVING BRANCHES





## FROM THE PRESIDENT'S DESK

# MOVING FORWARD TOGETHER

I'D LIKE TO TAKE THE TIME to acknowledge the resilience of Living Branches and how grateful I am for this community. Over the past several months, we watched our campuses slowly transform as Covid cases stayed low and vaccination rates climbed. In many ways, this season was about bringing joy and happiness back to campus.

All the while, we've remained vigilant in fighting against a virus that is frankly very much still here. That's the challenge: prioritizing the physical health of our residents without neglecting emotional wellbeing, and finding that balance between staying safe and resuming life-enriching activities for all to enjoy.

It's remarkable that, even throughout the pandemic, we haven't lost sight of our mission: serving and empowering all residents. Moving forward, The Campaign for Living Branches aims to do exactly that. Creating more private rooms in Health Care and Memory Care will allow residents' interactions with family to be as personal and unique as possible.

The capital campaign makes me reflect on interactions that I've had with my own family in Health Care. When both of my parents were at Landis Homes in Lancaster, I realized how impactful a private setting was on our time together. It has been a goal of mine to bring these accommodations to Living Branches, and I hope that you're just as excited to watch this become a reality.

Now more than ever, I believe it's clear how important it is to feel connected to loved ones and to our community. I think about a family friend of mine, Julie Gotwals, who often brings flowers into Souderton Mennonite Homes. Living Branches is so lucky to receive such beautiful flowers that she shares from her garden. Years ago, Julie would visit Souderton to spend time with family members that resided there. Although her relatives aren't with us anymore, her desire to brighten the lives of residents and staff lives on.

Julie's attention to the flower garden at Souderton, and how involved she continues to be in our community, serves as an example of the ongoing circle of care that exists at Living Branches. I am blessed to be a part of an organization that fosters such strong friendships over time, and it's truly a special thing to watch them stay intact year after year. As we build for a better future, it is these kinds of familial connections that assure me that we'll navigate all uncertainty, and overcome any obstacles, together.

*Edward D. Brubaker*

EDWARD D. BRUBAKER  
President/CEO

## BRANCHING OUT

A PUBLICATION OF LIVING BRANCHES

*Together we empower older adults and families to lead lives of purpose and joy, guided by the Mennonite tradition of care and service to others.*

### EXECUTIVE LEADERSHIP TEAM

Edward D. Brubaker, NHA  
President/CEO  
Monique L. Cole, NHA/PCHA  
Executive Director, Souderton Mennonite Homes and The Willows of Living Branches  
Brandon Kastner, MBA, NHA  
Executive Director, Dock Woods  
Alexandra K. Metricarti, MBA  
Chief Marketing and Public Relations Officer  
Steven D. Myers, MBA  
Chief Financial and Technology Officer  
Katherine S. Shott, MBA, NHA, SHRM-SCP  
Chief Human Resources Officer

### BOARD OF DIRECTORS

Kenneth J. Clemmer, Chair  
John W. Duerksen, Vice Chair  
Angela S. Hackman, Secretary  
L. Brent Kolb, Treasurer  
J. Todd Alderfer, MD  
Luke J. Bergey  
J. Oliver Gingrich  
Bryan K. Hunsberger  
Amy L. Kolb  
Joshua J. Meyer  
Jane L. Ruth  
Wendell J. Weaver  
Edward D. Brubaker, President

### EDITORIAL STAFF

Alexandra K. Metricarti, Editor-in-Chief  
Payton E. Breidinger, Managing Editor

Contact Branching Out at 215-368-4438 or  
BranchingOut@LivingBranches.org

Living Branches maintains a mailing list of people who we feel are interested in the activities, events, programs, and services of our communities. If for any reason you want your name removed from this list, please email the editor with your name, address, and request at BranchingOut@LivingBranches.org

Living Branches is a member of:



## Table of Contents

- 4 Life Blossoms at Living Branches  
*Residents and staff celebrate the safe reopening of activities and amenities on the Living Branches campuses.*

- 8 Building For the Future: The Campaign for Living Branches  
*Rooted in Love. Growing Together. An overview of The Campaign for Living Branches and how it aims to enhance residents' living spaces and the quality of creative arts therapies.*

- 12 Community Updates  
*Meet Dock Woods' new executive director, Brandon Kastner, and preview the artwork that has been placed throughout Dock Woods and Souderton Mennonite Homes.*

- 13 Living Branches Employees Receive Scholarships for Committing to Higher Education  
*Living Branches congratulates scholarship recipients from our state association, LeadingAge PA, and from the Nursing Scholarship Fund.*

- 14 Campus Happenings  
*Living Branches enjoys an in-person Living U semester, residents get creative around campus, and Edward Brubaker celebrates a milestone birthday with ice cream for everyone!*

- 16 Charitable Donations to Living Branches Foundation  
*Donations received from January 1, 2021 through June 30, 2021.*





# LIFE Blossoms *at Living Branches*

FOR MANY, THE COVID vaccine brought the hope of returning to life as we once knew it and lived it on the Living Branches campuses. Just in time for summer, it seemed like the sun finally began to shine through the layer of clouds that had been hanging over our heads since early 2020. While we've remained cautious and considerate of others' safety, the continued cooperation of our residents and staff has allowed us to bask in the sunlight.

Now that several months have gone by since holding vaccine clinics on campus, we are proud to report that around 95% of all Living Branches residents, and 82% of employees are vaccinated. With these high vaccination rates, residents have been able to resume some of their most beloved activities and hobbies.

We watched excitedly as visitors entered into our hallways to reunite with residents in all levels of care. Our doors have remained open for those who pass the proper set of screening questions, and our cafes accommodate vaccinated guests who wish to share a meal with their loved ones. We've brushed the dust off of library books, hung the 'open' sign in the gift shop windows for residents and guests at Souderton Mennonite Homes and Dock Woods, and have been able to take trips to visit the park, for ice cream, and to go bowling.

Though the future is unpredictable, our faith and trust in this community will carry us through any obstacles that remain in our path. In the meantime, we ought to embrace the victories — no matter how small — and come together as long as it is safe to do so. May we never forget the loss and hardships that all residents and staff have endured over the past year, but look forward to celebrating the life that has started to bloom again at Living Branches.





### CREATIVE ARTS THERAPY CONTINUES TO BRANCH OUT

Over the past few months, creative arts therapy coordinator, Seth Laucks, and his team of student interns worked diligently to expand a program that brings happiness and camaraderie to residents in all levels of care. Our skilled interns taught the basics of dance to promote a healthy body, meditation to promote a healthy mind, and art to promote an active imagination. When connection and community was needed the most, creative arts therapy helped enrich the lives of many.

Living Branches welcomed its very first art therapist, Dana Shafer, this spring. As part of her internship, one of Dana's projects was completed with the help of residents at The Willows. Together residents created a piece of artwork that now hangs proudly near The Willows' front desk. The large canvas painting of a tree symbolizes Living Branches' experience of living through a pandemic: practicing faith, spreading hope, and coming together as a community.



### SOUDERTON MENNONITE HOMES CELEBRATES ITS RESIDENTS' COMMITMENT TO LOVE

One day this summer, Pastor Joy Sawatzky took her usual spot behind the podium in the Summit View Auditorium. Although when she looked out into the audience, the sight was anything but ordinary: pink and silver balloons decorated the backs of chairs, flower petals covered tabletops, and bottles of sparkling cider were ready in the back of the room. For the first time since 2005, Souderton Mennonite Homes held a ceremony for its married residents to renew wedding vows with their spouse. More than 20 couples attended, and many friends and families watched the event live from their homes, too.

During the ceremony, Pastor Joy encouraged attendees to indicate the number of years they had been married for by raising their hands. "Less than a year?" she asked. "Less than 10 years?" she continued, but received little response from the crowd. As the milestones she listed increased in years, more and more hands lifted proudly in the air. The majority of couples shared that they were nearing 65 years of marriage. When it came time to renew vows, each partner shifted toward each other, locked eyes, and repeated the blessing that Pastor Joy read aloud.

A reception was held following the service, where residents chatted amongst each other, enjoyed light refreshments, and took turns sharing personal stories from the day they exchanged vows the first time.





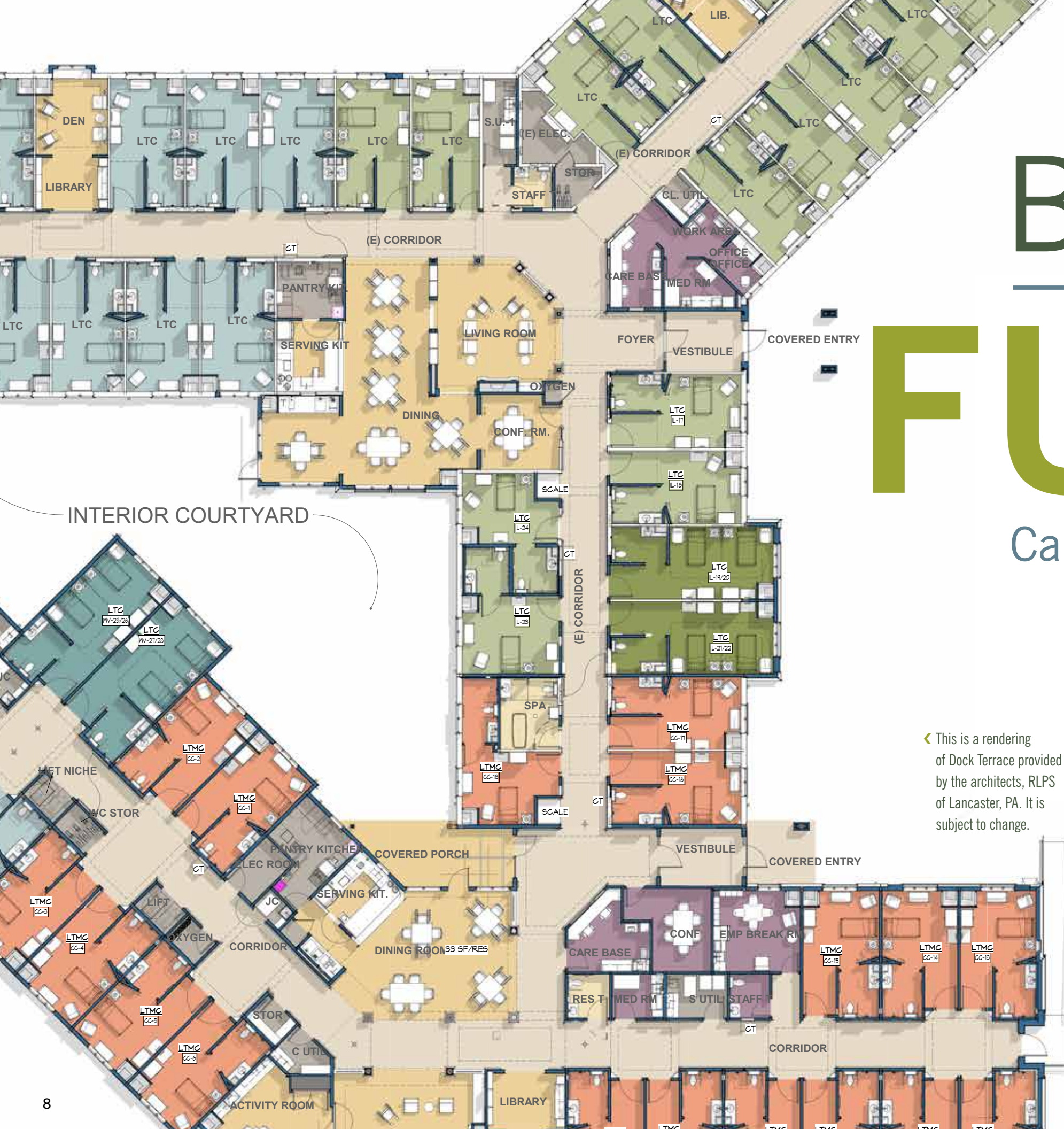

# BUILDING FOR THE FUTURE

Campaign for Living Branches

## ROOTED IN LOVE. GROWING TOGETHER.

◀ This is a rendering of Dock Terrace provided by the architects, RLPS of Lancaster, PA. It is subject to change.

These are the words driving the campaign that focuses on the future of Living Branches, one that will bring more joy and support to our residents. As we continue to grow and evolve together, we recognize the importance of adapting and upgrading our our Health Care and Memory Care settings. The Campaign for Living Branches addresses the changing needs for our community's quality of care and comfort, and works to further enrich our residents' lives. Over the next few years, this will be achieved through creating more private rooms and living spaces, as well as ensuring the funding of our creative arts therapy program.





### GROWING TOGETHER WITH BUILDING UPDATES

When Living Branches first designed its Health Care and Memory Care neighborhoods, the standard was to provide residents with double rooms and large common spaces. However these accommodations now reflect outdated trends. Over the years, approaches in health care have become increasingly personalized to fit individual needs. In order to best serve our residents, we must make appropriate upgrades within our communities.

Donations designated toward Growing Together with Building Updates will help support significant enhancements including private suites for residents in Health Care and Memory Care, each with a private bathroom and easily accessible shower.

The renovations also include the addition of beautifully landscaped courtyards and multiple living areas that will foster a greater sense of community. Discreet nursing stations and family-style kitchen will make residents feel at home.

To Glenn Bergey, having one of the few private suites in Souderton Mennonite Homes during his wife, Lourene's, time in hospice care was incredibly meaningful to his family. He shared that his children, as well as extended relatives, were able to focus on what was important to their loved one: visiting regularly and enjoying activities together.

*“I hope more families can take advantage of the private rooms planned at Living Branches.”*  
– Glenn Bergey



### GROWING TOGETHER WITH CREATIVE ARTS THERAPY

Another objective of The Campaign for Living Branches is to ensure funding of the creative arts therapy program. Seth Laucks, our expert in music therapy, uses music to enhance the lives of residents and the care they receive on our campuses. In his role as creative arts therapy coordinator, Seth also mentors interns and trains other staff persons to implement creative arts methods into residents' routines. Donations designated to Growing Together with Creative Arts Therapy will increase the capacity for our team to offer joyful experiences in music, art, and dance.







## JULIE GOTWALS GIVES BACK TO SOUDERTON MENNONITE HOMES

If you've visited Souderton Mennonite Homes in the summertime, you might have noticed the beautiful flowers that decorate the front desk and are placed throughout the campus. We're pleased to introduce you to the face behind these pretty arrangements. Julie Gotwals, a close friend and familiar face to many in the Living Branches community, often shares what grows on her family's farm in the warmer months.

Just a few miles down the road from Souderton Mennonites Homes is Detweiler Homestead Farm: a farm that sells flowers and home-grown vegetables. For four generations, Julie's family has maintained the farm, raising all kinds of beautiful flowers. It's always a pleasure to see the smiles that bloom on residents' faces whenever she brings around such vibrant bouquets, including the lisianthus – a particular favorite at Souderton Mennonite Homes. Living Branches thanks Julie for brightening the lives of those who reside in, work at, or visit Souderton Mennonite Homes!

## LIVING BRANCHES PARTICIPATES IN RESEARCH STUDY:

### *What Role Does Music Therapy Play in the Transition to Long-Term Care?*

Living Branches is beginning a new research project that aims to explore the impact of music therapy on residents' transitions into long-term care. Brigitte Schneible, Drexel University PhD candidate, will be conducting interviews on campus over the next several months. Brigitte's background in music therapy encompasses more than a decade's worth of experience in working at skilled nursing facilities to enrich the lives of residents.

By speaking with members of the Living Branches community, Brigitte intends to better understand how music therapy might affect residents as they transition into Personal Care, Health Care, or other long-term care settings.

Residents may be eligible for the study if they've lived in Personal Care or Health Care for less than one year, and have participated in group or one-on-one music therapy sessions. When asked about her experience so far, she had only kind remarks to share toward Living Branches. "The residents have been so lovely to speak with," she said. "They're all so mindful about being helpful toward the study, and they're excited to see it going toward my education."

Residents who are both eligible and interested in participating are encouraged to contact Seth Laucks at [Seth.Laucks@livingbranches.org](mailto:Seth.Laucks@livingbranches.org). Seth is happy to receive any resident referrals, too, on behalf of staff, families, or fellow residents!

## NEW ARTWORK FILLS THE HALLWAYS IN SOUDERTON MENNONITE HOMES AND DOCK WOODS

Personal Care at Souderton Mennonite Homes has received a new look after a recent renovation project. TV lounges and community kitchenettes have been freshly painted and redecorated, and artwork has been recently installed. By the middle of the summer, it was Dock Woods turn for a refresh. As the last step in the renovation of the campus, new artwork filled hallways, recreation areas, and dining rooms. Over the course of a week, more than 200 paintings, canvas photographs, and other decorations gave life to walls that had previously been bare. From scenic country landscapes to more abstract décor, residents and visitors are bound to find a piece that resonates with them.



## MEET BRANDON KASTNER: EXECUTIVE DIRECTOR AT DOCK WOODS

We are pleased to welcome Brandon Kastner to Living Branches as the new executive director for Dock Woods. Brandon joined the team in early July, arriving from Lexington, Virginia, where he served as the health facility administrator for Kendal at Lexington, a life plan community. He has worked with senior adults all throughout his career, as he also previously worked as the associate executive director at Glenaire, a life plan community in Cary, North Carolina. In addition to earning a bachelor's degree in history and his Master of Business Administration, Brandon is currently working toward a master's degree in non-profit administration from the University of Notre Dame. He and his wife, Tasha, are the parents of two young sons, Jack and Joey.



## LEADINGAGE PA AWARDS SCHOLARSHIPS TO LIVING BRANCHES EMPLOYEES

We're excited to congratulate two Living Branches employees on receiving scholarship awards from our state association, LeadingAge PA. Dawn Maher, resident assistant at Souderton Mennonite Homes, and Kristin Varilla, dining services assistant at The Willows of Living Branches, both applied for and earned \$1,200 scholarships. The award was presented to Dawn and Kristin by Megan Stedjan, LeadingAge PA's director of member engagement. The Living Branches community wishes Dawn and Kristin the best of luck in their studies.

## SUPPORTING OUR STAFF THROUGH THE NURSING SCHOLARSHIP FUND

The Nursing Scholarship Fund enables Living Branches to provide financial assistance to part-time, full-time, and weekend employees who are working toward earning a degree in nursing. Awarding scholarships to our staff encourages the pursuit of higher education, which in turn allows for our residents to receive the highest levels of care possible. Congratulations to the recipients of the 2021 nursing scholarships: Sierra Crino, Silvia Gonzalez, Morgan Klaumenzer, Michaela Miller, Alyssa Myers, Nancy Wetzell, and Kristin Varilla!



## LIVING U RETURNS TO IN-PERSON INSTRUCTION FOR FALL 2021 SEMESTER (1)

Living Branches is happy to host in-person classes for the fall semester of Living U! Thanks to the community outreach efforts of the Living U curriculum council, and coordinator Maribeth Benner, residents were offered a record-breaking number of courses to choose from. Though a few courses will still be taught over Zoom, the majority of the 31 total classes invite both instructors and participants to gather in Summit View Auditorium, Fisher Auditorium, or Dock Woods Chapel. This was also the first semester that participants were able to pay for their registration online directly through the Living Branches website. Living U's fall classes range from topics such as therapy dogs to the history of the Hatfield Packing Company, and even includes a field trip to the Francis B. Shaw Historic District in Doylestown.



## SOUDERTON RESIDENTS LEARN THE ART OF PAPERMAKING (2)

Each month we fill our life enrichment calendars with opportunities for residents to participate in activities that are interesting and engaging. This summer at Souderton Mennonite Homes, one of the many events offered for residents was to make paper from scratch. Under the instruction of in-house artist, Libby Musselman, Souderton residents gathered outside for a lesson on papermaking. Those in attendance were enlightened about the process, as they tried using matted sheets of cellulose fibers, a wire screen, and water to create paper right here on campus!



## PRESIDENT EDWARD BRUBAKER'S BIRTHDAY CELEBRATION: ICE CREAM TRUCKS COME TO CAMPUS! (3)

Our residents and staff were in for a special treat this summer! As our we continued to focus on the positivity and happiness we could bring to our campuses, president/CEO, Edward Brubaker, invited the Living Branches community to celebrate a major milestone with him. For his 60th birthday, he arranged for a Downtown Scoop ice cream truck to visit The Willows of Living Branches, Souderton Mennonite Homes, and Dock Woods. Underneath the warm August sun, residents and staff persons enjoyed their ice cream. The event created afternoons of celebration, genuine camaraderie, and light-hearted conversation amongst the Living Branches family.





# Charitable Donations to the Living Branches Foundation

JANUARY 1, 2021 TO JUNE 30, 2021

## Gifts to the Agape Fund

Audrey J. Alderfer  
Ruth Baker  
Curtis and Esther Bergey  
Family Foundation  
Verna Delp  
Leon and Elaine Derstine  
Paul M. and Eleanor Derstine  
Frederick's Flowers & Gifts  
Harvey and Grace Freed  
Joan L. Freed  
William B. Freed  
Ivan and Merrie Gehman  
Sara Gehman  
Linneaus and Elsie G. Godshall  
Linda Hayden  
Ruth Hertzler  
Joyce Hunsberger  
Shirley Keller  
Alice Kolb  
Evelyn Meyers  
Gladys Nyce  
Plains Mennonite Church  
Nelson S. Souder Foundation  
Endowment  
Souderton Mennonite Homes  
Souderton Mennonite Homes  
Auxiliary  
Towamencin Mennonite Church  
Raymond and Linda Trauger  
Galen and Carolyn Wenger  
Ray K. Yoder

## Gifts to the Dock Village Youth Fund

Henry and Charlotte Rosenberger  
Robert and Olive Turnipseed  
Salford Mennonite Church

## Gifts to the Fund for Housing for Retired Church Workers

J. Mark and Emma Frederick  
Noah and Sara Kolb

## Gifts to the Living Branches Benevolent Care Fund

Lester and Louise Alderfer  
AmazonSmile  
Randy and Cathy Annis  
Anonymous  
Backyard Beans Coffee Company  
Ruth Baker  
Gordon R. and Velda M. Beidler  
Gordon and Joan Bell  
Joan Bellitto  
Franklin and Katharine Bennett  
Willard and Glenda Bergey  
William and Anne Bishop  
Lori and Christian Borglum  
Paul Bowen  
Edward and Lucy Brubaker  
William and Barbara Burnett  
John and Nancy Butterwick  
CAF America  
Margaret Caltabiano  
Robert Campbell  
Elizabeth Casmus  
Arlayne Clemens  
Elaine Clemmer  
Stephen and Kim Cluff  
Monique and Benjamin Cole  
Larry and Lisa Connolly  
J. Stanley Davis  
John Dearden  
Robert and Ginny Dell  
Althea Detwiler  
Rita DiLucia  
Dock Woods  
Nancy and Thomas Donnelly  
Walter and Naomi Dublanica  
Nicholas and Marie Duczak  
John and Carol Eells  
Carol Folcarelli  
Franconia Insurance  
and Financial Services  
Judy Frankel  
Verna Garges  
Ted Gody

James and Donna Gresh  
Merlin and Mary Grieser  
Hiram and Carol Gross  
Norman and Judith Hartzel  
Heacock Lumber  
Keith and Betsy Heavener  
P. Scott Heckler  
William and Mary Anne Hildebrand  
Estate of Leona Hoffman  
Charles Richard Hollenbach  
Rodney and Lisa Hunsberger  
Illinois Tool Works, Inc.  
Richard and Colette Karuschkat  
Elizabeth Kinzie  
Robert and Dana Koehler  
Brian and Amy Kolb  
Dorothy Kratz  
Floyd and Debra Kratz  
William and Donna Kriner  
Gregory and Ellen Lacher  
Sandy and Steven Landes  
Joseph and Janet Landis  
Landis Decorating  
Richard and Sandra Linberger  
Henry and Carol Longacre  
Kenneth and Cindy Longacre  
Francis and Mary Loughran  
Ronald and Diane Ludwig  
Estate of Marion Prochazka  
Sandra McBride  
Alexandra and William Metricarti  
Kathleen M. Mitchell  
Abram and Glenda Moyer  
J. Phillip and Betsy Moyer  
Ruth L. Moyer  
Ruth H. Moyer  
Richard and Judith Mumaugh  
J. Kerrin and Lisa Musselman  
Steven and Georgia Myers  
Frances Nikles  
North Wales Podiatry  
Lorene Nyce  
David and Karen Olson  
Ray and Sandra Paine  
Adam and Judith Paterson

Robert Pecharo  
Robert and Elizabeth Peterson  
George and Carol Pratt  
Jean Press  
Lorraine Priestman  
Providence Mennonite Church  
Eileen Prusinski  
R. E. Morrison Contracting Inc.  
Kenneth and Beverly Ralphs  
RBC Wealth Management  
Mary Reaser  
Al and Kim Richter  
Richter Drafting & Office Supply  
Norman D. Rittenhouse  
Roy Rittenhouse  
Jorge and Mary Rodriquez  
Salford Mennonite Church  
Thomas and Shirley Sanders  
John and Eva Seeton  
Joan Seitzinger  
Katherine and James Shott  
Joyce Shultz  
Thomas & Loretta Slattery  
E. Dianne Smith  
Ronald and Susan Souder  
Roger and Patricia Stauffer  
Wayne and Marian Steinly  
Lawrence and Deborah Stevens  
Lois Stevens  
Mary Stoneback  
Perry and Carol Townsend  
John and Linda Tyson  
Unidine Lifestyles  
United Way of Greater Philadelphia  
& SNJ  
Usborne Books & More  
Vanguard  
Al and Carol Vara  
Janet Vincent  
Robert E. Wendig  
Diane Wetherill  
Robert and Anita Winder  
Dena and David Winner  
Gloria Zeigler

## Gifts to the Restricted Gifts Fund

Charles Dye, Jr. and  
Elizabeth Hallman-Dye

## Gifts to the Rooted in Love. Growing Together. Campaign: Building Updates

The Bergey Family Foundation  
The Edward and Lucy Brubaker  
Charitable Fund  
Kenneth and Gayle Clemmer  
John and Sheila Duerksen  
P. Scott Heckler  
Bryan and Barbara Hunsberger  
Arlin and Esther Shisler  
Univest Bank and Trust Co.

## Gifts to the Rooted in Love. Growing Together. Campaign: Creative Arts Therapy Fund

Lisa Halteman and Michael Meyer  
Perry J. and Carol Townsend

## Gifts to the Rooted in Love. Growing Together. Campaign: LBBCF

K. Leon and Dawn Moyer

## Gifts to the Sharing Fund

Abdelsalam Corporation,  
dba Linli Jewelry  
Ferne C. Alderfer  
Estate of Maxine Derstine  
Walter and Naomi Dublanica  
Karen Foley  
Carolyn Gordon  
Jane Littman  
Margaret OMalley  
Raymond and Nancy Scherfel  
Harry and Ann Sharff  
Stephen and Cheryl Wilson

## GIFTS IN HONOR

**Lori Borglum**  
Bruce and Deborah Alder

**Karl and Margie Buckholz**  
Robert Campbell

**Nancy Donnelly**  
Bruce and Deborah Alder

**Dock Terrace Nursing Staff**  
Frederick and Terry Shisler

**Carolyn Gordon**  
Paul Gordon

**Mike Hoch and Environmental  
Services Staff**  
J. Stanley Davis

**Living Branches Staff  
& Administration**  
Robert and Barbara Houston

**Thelma Mack**  
Bruce and Shirley Musselman

**Marie Miller**  
Ronald and Diane Miller

**Maria R. Preedy**  
Theresa Rakszawski

**Patti Wright**  
Bruce and Deborah Alder

## GIFTS IN MEMORY

**Richard Adams**  
Amy Adams

**Meredith Albertson**  
Edith Wetherill

**Wayne Althouse**  
Victor and Marie Stoltzfus

**Rose Bartholomew**  
Sherry Gehman

**Arlene Bergey**  
Barbara Thompson

**Jean Beyerle**  
Doris Fenton  
Robert and Barbara Houston  
Edith Wetherill

**Virginia Brower**  
Karen Brower

**Olga Chaplynsky**  
Thomas and Alice Keim

**Warren Cooper**  
Bill and Jerelyn Pugh

**Marie Dell**  
Marilyn Alderfer  
Laser Components USA, Inc.

**R. Lee Delp**  
William and Florence Kuhfuss

**Clair Derstine**  
Grace Brenneman  
Jim and Barbara Butler  
James and Sandra Godshall  
Keith and Betsy Heavener  
Douglas and Melanie Johnson  
Phyllis Kooker  
Plains Mennonite Church

**David and Maxine Derstine**  
Daryl and Julie Derstine

**Lois Detweiler**  
Kathryn Halteman

**Walter Detweiler**  
Murrey and Arlene Alderfer  
Kurt and Kathleen Christie  
Phyllis Kooker

**Margaret "Peg" Freed**  
Thomas and Jean Beggs  
Robert and Sharon Bishop  
Betty M. Hackman  
Alta Pelkey

**Verna Fretz**  
Gerald Cape  
Lawrence and S. Ann Cooper

**Pearl Fulmer**  
Ann Sheasley

**Samuel A. Godshall**  
Bruce and Deborah Alder



**Sadie Grass**  
Raymond and Linda Trauger

**Myrtle Guldin**  
Christine Ciaudelli  
Judith Macrone

**Betty Hagey**  
James and Jane Clough

**Russell Halteman**  
Dean Crouthamel  
Kelly Grant

**Mary Koller**  
Joseph and Monica Catanzaro  
Francis Koller

**Nevin Kratz**  
Millard Showalter and Mary Kratz

**John "Jack" Larkin**  
Nancy Hemmerle  
Nancy Cuthbertson  
Doris Fenton  
E. Richard and Roberta Hittinger  
Elizabeth Levering  
Ruth L. Moyer  
George and Nancy Renner  
Catherine Wood Naughton

**Grace Leatherman**  
Souderton Mennonite Homes  
Auxiliary

**William McNamara**  
Edgar and Faith Hendler

**James Miller**  
Ronald and Diane Miller

**Joseph Nosek**  
Kenneth and Maureen Bullwinkle  
Charles and Betty Fuller  
Earl and Kate Long  
Jeanette McElrone  
Sarah Murray  
Mary Ann Vettese  
Kathleen Webster and Teresa Galetti

**Allen Pannell**  
Anonymous

John Dearden  
Althea Detwiler  
Walter and Naomi Dublanica  
Doris Fenton  
Robert H. Heacock  
William and Mary Anne Hildebrand  
Robert and Barbara Houston  
Patricia McNamara  
Lenore Roscioli  
Paul and Sheila Roth  
Dolores Rupley  
Joyce Shultz  
Rosalie Smith  
Robert and Barbara Thompson  
Bruce and Hilda Weinger  
Edith Wetherill

**Kathleen Perry**  
G. Creston Campbell  
George and Jean Hogshead  
Reverend Dorothy E. Shelly

**Jessica Priestman**  
Lorraine Priestman

**Eleanor Ruth**  
Robert and Barbara Houston  
S. Duane Kauffman  
William and Florence Kuhfuss

**Sarah Seip**  
Patricia McNamara

**Dorothy Stefanco**  
Doug and Charlene Rogers  
Doris Fenton

**John Swartley**  
Schwab Charitable Fund

**Roger Wardlow**  
John Dearden  
Althea Detwiler  
Brian and Louise Flynn  
Robert and Barbara Houston  
Francis and Mary Loughran  
Jude Reardon and Jordan Flynn  
Walter and Margaret Sames  
Joyce Shultz  
Miriam Spence  
Robert and Barbara Thompson



**Betty Yerger**  
Alma Bauer  
Mike and Carolyn Kaelin  
Eugene and Susan Schmoyer  
Doris Texter  
Shirley Texter  
Bruce and Laurene Yerger

**Dorothy Young**  
Betty M. Hackman

**BENEVOLENT CARE PARTNERS**

*Event*

**COMMITTED TO ANNUAL GIFTS OF \$18,000 OR MORE**

Bergey's Inc.  
Contract Pharmacy

*Platinum*

**COMMITTED TO ANNUAL GIFTS OF \$10,000 OR MORE**

Univest Bank and Trust Co  
Everence Financial Services

*Gold*

**COMMITTED TO ANNUAL GIFTS OF \$6,000 OR MORE**

Alderfer Glass Company  
Lacher & Associates

*Silver*

**COMMITTED TO ANNUAL GIFTS OF \$3,000 OR MORE**

Benchmark Construction  
Bergey's Electric, Inc.  
Clarke's Landscaping & Lawn Care, Inc.  
Good Plumbing, Heating, Air Conditioning, Inc.  
Henning's Market  
John Garis Homes, Inc.  
Moyer Indoor/Outdoor  
Perkiomen Tours  
RLPS Architects  
Thomas & Boyds, Inc.

*Bronze*

**COMMITTED TO ANNUAL GIFTS OF \$1,500 OR MORE**

AIA Alera Group  
Baker Tilly Virchow Krause, LLP  
C & S Lawn Landscaping, Inc.  
Clemens Food Group  
Delcrest Medical Services  
DunlapSLK, CPAs  
Harleysville Bank  
Horgan Brothers, Inc.  
IT Landes  
Indian Valley Camping Center  
Ivan Gehman Painting & Wallpapering  
J.L. Freed Honda  
Latsha Davis & Marshall  
R.J.L. Services, Inc.  
Select Rehabilitation Services  
Sliwinski Floor Coverings  
Weaver, Reckner & Reinhart Dental Associates  
Williams-Bergey-Koffel Funeral Home, Inc.

**LEGACY GIVING MEMBERS**

*Circle of Love*

**PLANNED GIFTS, INCLUDING ESTATE GIFTS AND GIFT ANNUITIES**

Ferne C. Alderfer  
J. Todd and Donna Alderfer  
Anonymous  
Donald and Grace Baker  
Ruth Baker  
Gordon and Velda Beidler  
Gordon and Joan Bell  
William and Anne Bishop  
Edward and Lucy Brubaker  
David and Geraldine Cassel  
Scott Elliott  
John and Carol Eells  
Carol Folcarelli



William B. Freed  
Paula Godown  
Jane Graham  
Hiram and Carol Gross  
Noah and Sara Kolb  
Dan and Shirley Lapp  
Grace Leatherman  
Donna Longacre  
Alice Miller  
David F. Miller  
Willis A. Miller  
Theran and Marlene Mills  
Harry and Dorothy Moore  
K. Leon and Dawn Moyer  
Norman D. Rittenhouse  
Royden Rittenhouse  
Cheryl Ruehl  
Patricia Rumkevicius  
Eleanor Ruth  
Anthony Salmon  
Harry and Ann Sharff  
Arlin and Esther Shisler  
Marie F. Shisler  
Joy Shoop

Reuben and Carol Strawn  
Doris Texter  
Shirley Texter  
Robert and Olive Turnipseed  
Janet Vincent  
Gloria Zeigler

*Circle of Hope*

**LIFETIME CONTRIBUTIONS ABOVE \$25,000**

Alderfer Glass Company  
Ferne C. Alderfer  
Fred and Nancy Allegrezza  
Anonymous  
Donald and Grace Baker  
Gordon and Velda Beidler  
Gordon and Joan Bell  
Bergey's Electric  
Bergey's Inc.  
Edward and Lucy Brubaker  
Clarke's Landscaping & Lawn Care  
Arlayne Clemens  
Emily Clemens  
Kathryn Clemens  
Ken Clemens  
Richard and Donna Clemens  
Elaine Clemmer  
Clemens Food Group/  
Hatfield Quality Meats  
Jacob and Darlene Clemmer  
Kenneth and Gayle Clemmer  
Contract Pharmacy Services, Inc.

Curtis & Esther Bergey Family Foundation  
Delcrest Medical Services  
Craig and Marianne Dise  
DunlapSLK, CPAs  
Everence Financial Services  
Carol Folcarelli  
Franconia Mennonite Church  
William B. Freed  
Good Plumbing, Heating, Air Conditioning, Inc.  
Grace Mennonite Church  
Daryl and Barbara Hackman  
Lisa Halteman and Michael Meyer  
Howard Heckler  
P. Scott Heckler  
Bryan and Barbara Hunsberger  
John Garis Homes, Inc.  
The J. Kenneth Jones Family  
Keller Charitable Foundation, Inc.  
Wilbur and Marilyn Kriebel  
Lacher & Associates  
Latsha Davis & Marshall  
Roscoe Leatherman  
Bill and Katie Longacre  
Cora Longacre

Donna Longacre  
Henry and Carol Longacre  
Longacre Family Charitable Fund  
David and Joanne McCrork  
David F. Miller  
Timothy and Betty Mininger  
Eva S. Moyer  
J. Phillip and Betsy Moyer  
K. Leon and Dawn F. Moyer  
Steven and Georgia Myers  
Donald and Romaine Pannabecker  
Perkiomen Tours  
Plains Mennonite Church  
Providence Mennonite Church  
Allyn and Connie Richert  
Norman D. Rittenhouse  
Kathleen and Charles Roberts  
Henry and Charlotte Rosenberger  
Cheryl Ruehl  
Salford Mennonite Church  
Arlin and Esther Shisler  
Marie Shisler  
Souderton Mennonite Homes Auxiliary  
Ruth Swartley  
SynaTek Solutions  
Thomas & Boyds, Inc.  
Towamencin Mennonite Church  
Univest Bank and Trust Co.  
Wendell and Jolene Weaver  
Robert E. Wendig

*Circle of Faith*

**COMMITTED TO ANNUAL GIFTS OF \$500 OR MORE**

Lester and Louise Alderfer  
Carolyn and Rodney Allebach  
Anonymous (4)  
Ruth Baker  
Gordon and Velda Beidler  
Gordon and Joan Bell  
Frank and Kay Bennett  
Willard and Glenda Bergey  
Bill and Anne Bishop  
Lori and Christian Borglum  
Paul and Patricia Bowen  
Edward and Lucy Brubaker  
John and Nancy Butterwick  
Elizabeth Casmas  
David and Gerry Cassel  
Arlayne W. Clemens  
Elaine Clemmer  
Ken and Gayle Clemmer  
Monique and Benjamin Cole  
Larry and Lisa Connolly  
J. Stanley Davis  
Verna Delp  
Clair and Rosalie Derstine

Daryl and Julie Derstine  
Lois Derstine  
Althea Detwiler  
Rita DiLucia  
Charlotte Dimmig  
Maralyn Dimmig  
Nancy and Thomas Donnelly  
Walter and Naomi Dublanica  
Nicholas and Marie Duczak  
John and Sheila Duerksen  
John and Carol Eells  
Barbara Felton and William Brown  
Carol Folcarelli  
Nancy E. Frantz  
David and Esther Friesen  
Charlie and Rae Ann Glass  
Walter and Anne Godley  
Paula Godown  
Donna and Jeffrey Godshall  
Linneaus and Elsie Godshall  
Ted Gody  
Carolyn Gordon  
James and Donna Gresh  
Daryl and Barbara Hackman  
Norman and Judith Hartzel  
Keith and Betsy Heavener  
P. Scott Heckler  
Ruth Hertzler  
William and Mary Anne Hildebrand  
Charles Richard Hollenbach  
Jesse Houck  
Bryan and Barbara Hunsberger  
The J. Kenneth Jones Family  
Richard and Colette Karuschkat  
Frank and Elva Keenan  
Shirley G. Keller  
Ruth Kinsey  
Alice Kolb  
Floyd and Debra Kratz  
Vernon Kratz  
Wilbur and Marilyn Kriebel  
Bill and Donna Kriner  
Bill and Floss Kuhfuss  
Gregory and Ellen Lacher  
Sandy and Steven Landes  
Richard and Sandra Linberger  
Donna Longacre  
Henry and Carol Longacre  
Francis and Mary Loughran  
Ronald and Diane Ludwig  
Wilson and Patricia Marvel  
Donna Merow  
Alexandra and Bill Metricarti  
Evelyn Meyers  
Earl and Betty Mininger  
Kathleen M. Mitchell  
Jeryl and Geraldine Moore

Sharon Moran  
Abram and Glenda Moyer  
J. Phillip and Betsy Moyer  
K. Leon and Dawn F. Moyer  
Vesta Moyer  
Richard and Judy Mumaugh  
J. Kerrin and Lisa Musselman  
Roy and Annie Musselman  
Steven and Georgia Myers  
Fran Nikles  
Gladys Nyce  
David and Karen Olson  
Ray and Sandra Paine  
Barry and Carol Pratt  
Jean Press  
Eileen Prusinski  
Kenneth and Beverly Ralphs  
Al and Kim Richter  
Royden Rittenhouse  
Dolores Rupley  
Tom and Shirley Sanders  
Ray and Nancy Scherfel  
John and Eva Seeton  
Joan Seitzinger  
Randy and Sylvia Shelly  
Arlin and Esther Shisler  
Kathy and James Shott  
Joyce Shultz  
E. Dianne Smith  
Roger and Patricia Stauffer  
Lois Stevens  
Reuben and Carol Strawn  
Perry and Carol Townsend  
Kenneth Truscott  
Janet and Norman Vincent  
Robert E. Wendig  
Dean and Julie Wimmer  
Dena and David Winner  
Lorraine Zook  
Margaret and Wilmer Zook







275 Dock Drive • Lansdale, PA 19446  
**ADDRESS SERVICE REQUESTED**

**The Willows  
of Living Branches**  
2343 Bethlehem Pike  
Hatfield, PA 19440  
215-822-0688

**Souderton  
Mennonite Homes**  
207 W. Summit Street  
Souderton, PA 18964  
215-723-9881

**Dock Woods**  
275 Dock Drive  
Lansdale, PA 19446  
215-368-4438

Non-Profit  
U.S. Postage  
**PAID**  
Lansdale, Pa  
19446  
Permit No. 152



## DISCOVER LIVING BRANCHES

Discover Living Branches virtual events are available for Residential Living and Personal Care. We will explore the opportunities available and you will get a taste of how residents live and grow together as they lead lives that are joy-filled and purposeful. Registration is required for this free event. *To register, visit [www.livingbranches.org/events](http://www.livingbranches.org/events).*

## OR SCHEDULE YOUR TOUR FOR PERSONAL CARE

**Call Karen Walser at 215-412-5510**